

A
797 m²

001
Personenlift
16 Pers., 1250 kg

000
Haupt-
Treppenhaus
BF: 65.7 m²
- 1.10

003
Neben-
Treppenhaus
BF: 13.1 m²
- 1.10

004
Warenlift
2000 kg

006
Vorzone Lift
BF: 9.3 m²

011
Flucht-
korridor
BF: 22.4 m²
+/- 0.00

005
Anlieferung EG
BF: 47.3 m²
+/- 0.00

007
Rampe

008
Flucht-
Treppenhaus
BF: 20.9 m²
- 0.40 / - 1.10

Ausfahrt Einfahrt

alte Dübendorferstrasse

Brandbachstrasse

Industriestrasse

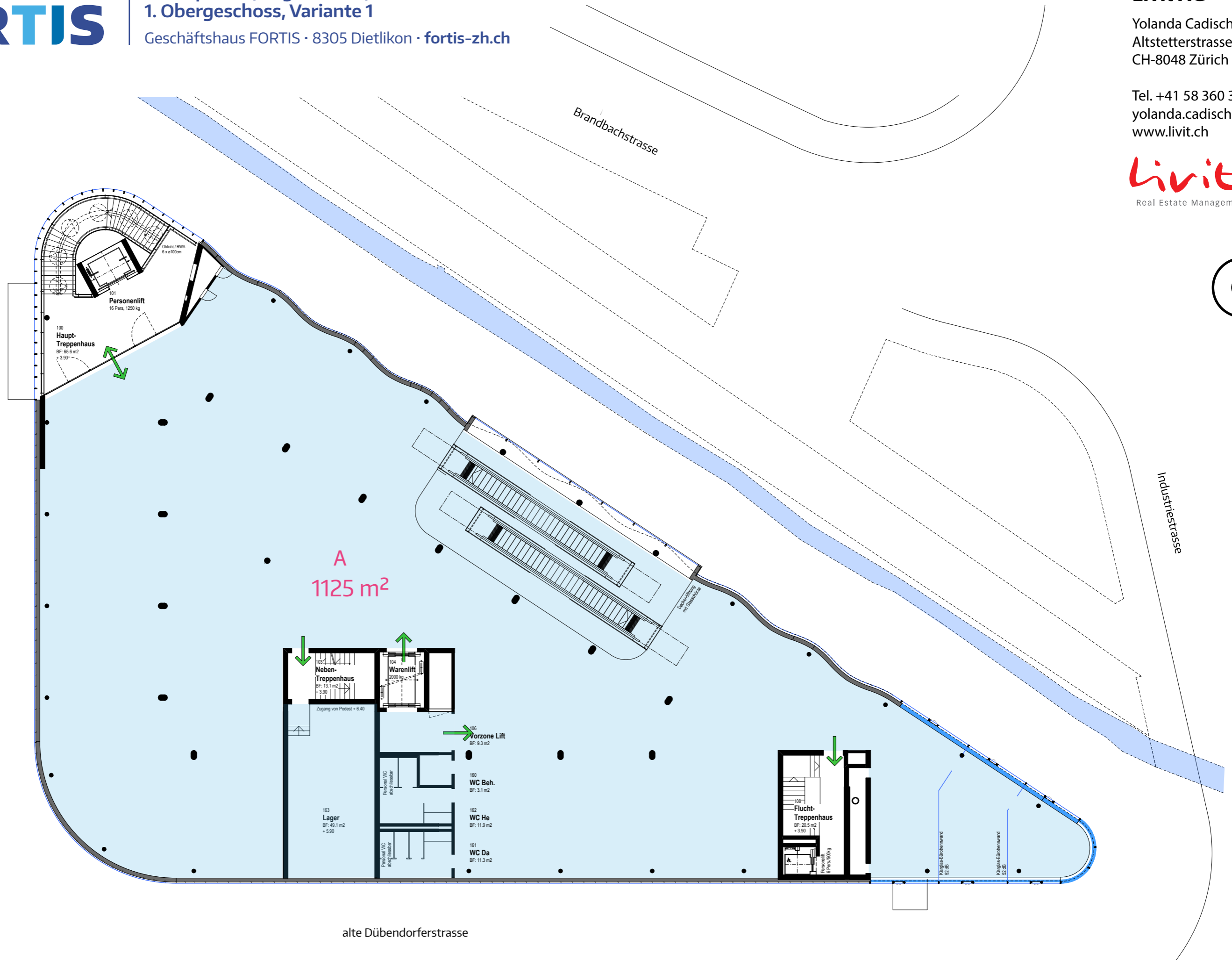
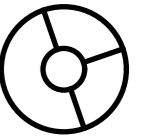

A
1125 m²

alte Dübendorferstrasse

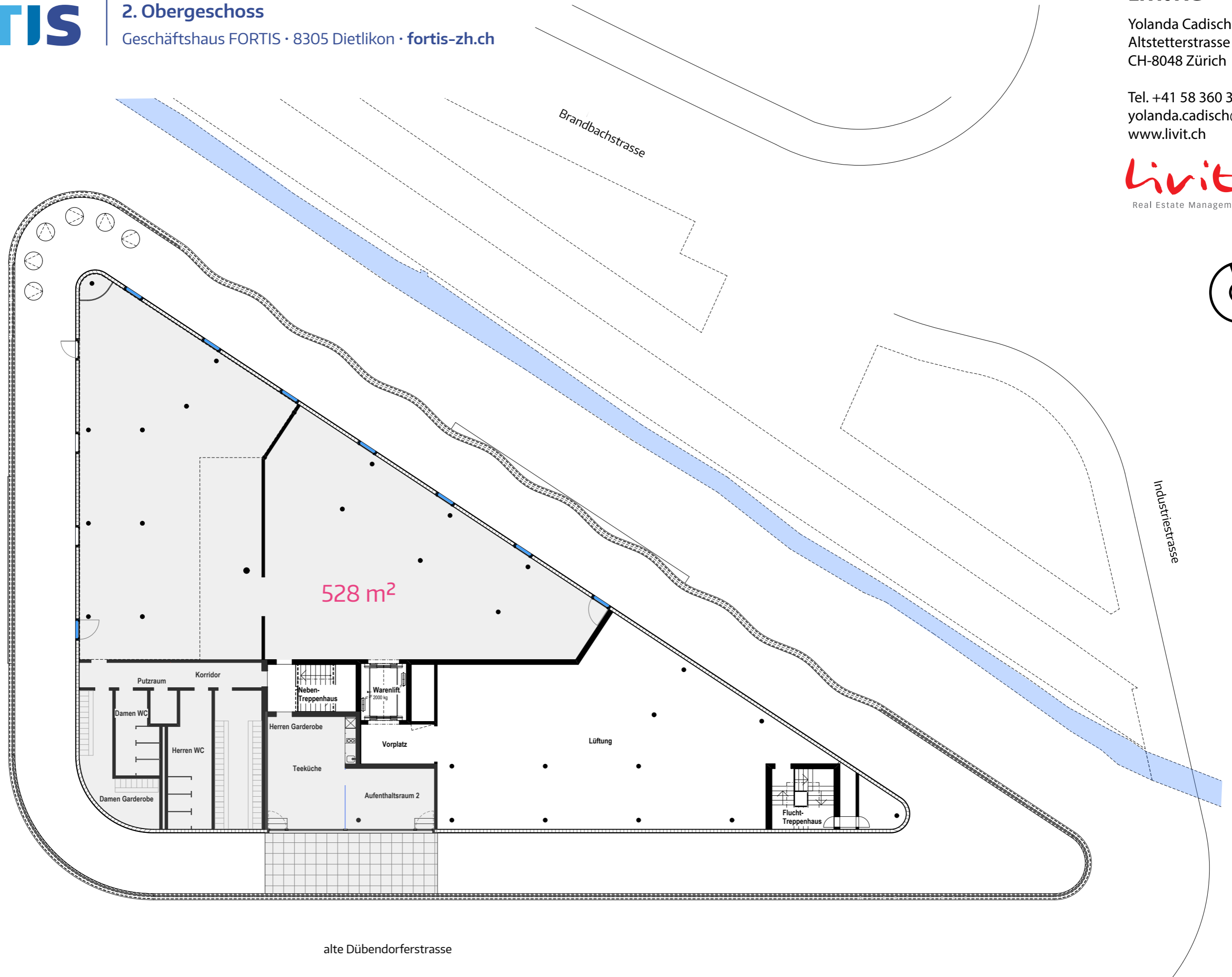
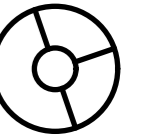

528 m²

alte Dübendorferstrasse

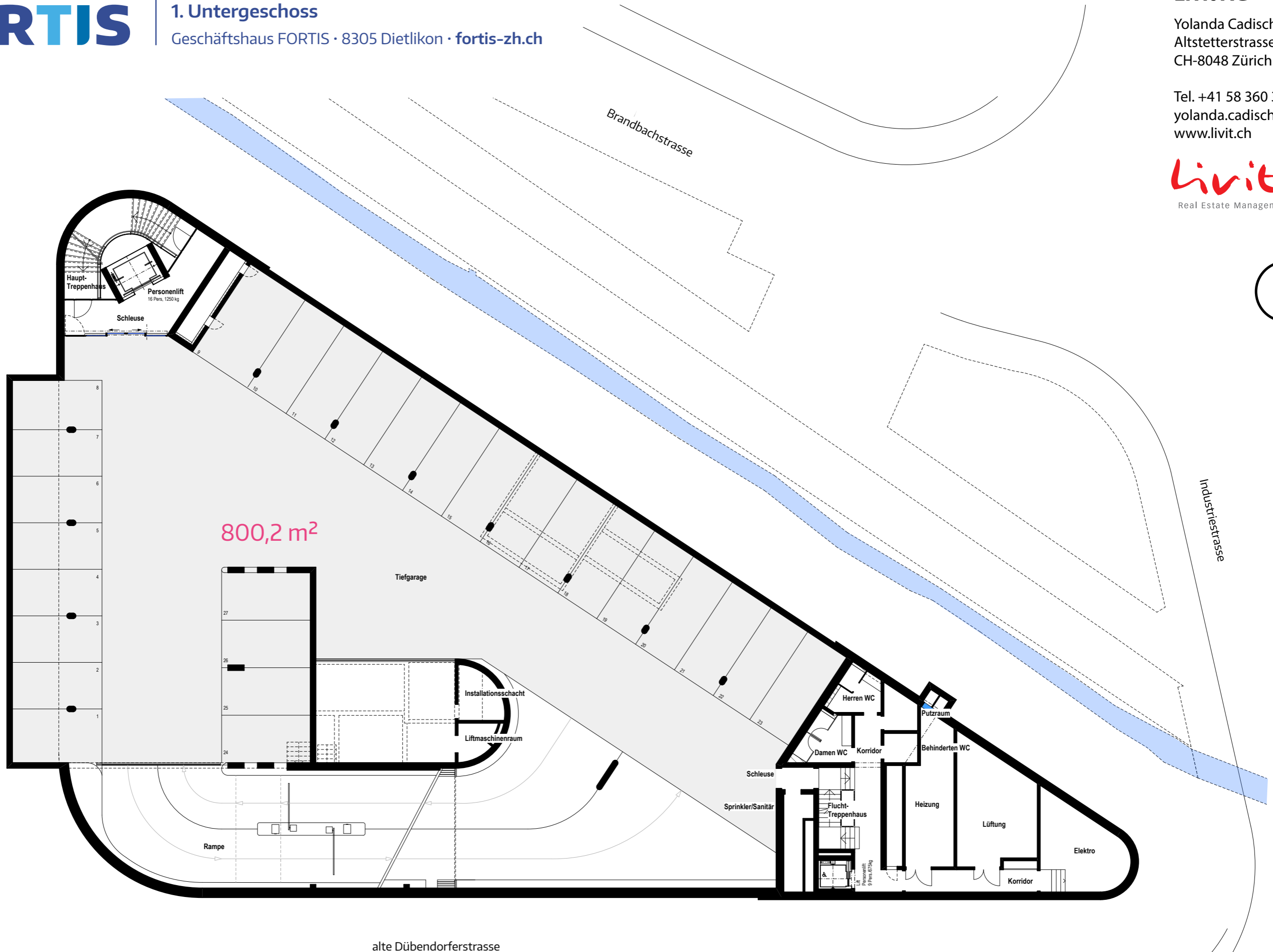
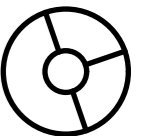

800,2 m²

alte Dübendorferstrasse

