

## 3.5-ZIMMER-WOHNUNG

Erdgeschoss - 2. Obergeschoss

### GEBÄUDE 60 E

Wohnung  
3.1.02

Nettowohnfläche  
65.1 m<sup>2</sup>

Loggia  
6.9 m<sup>2</sup>

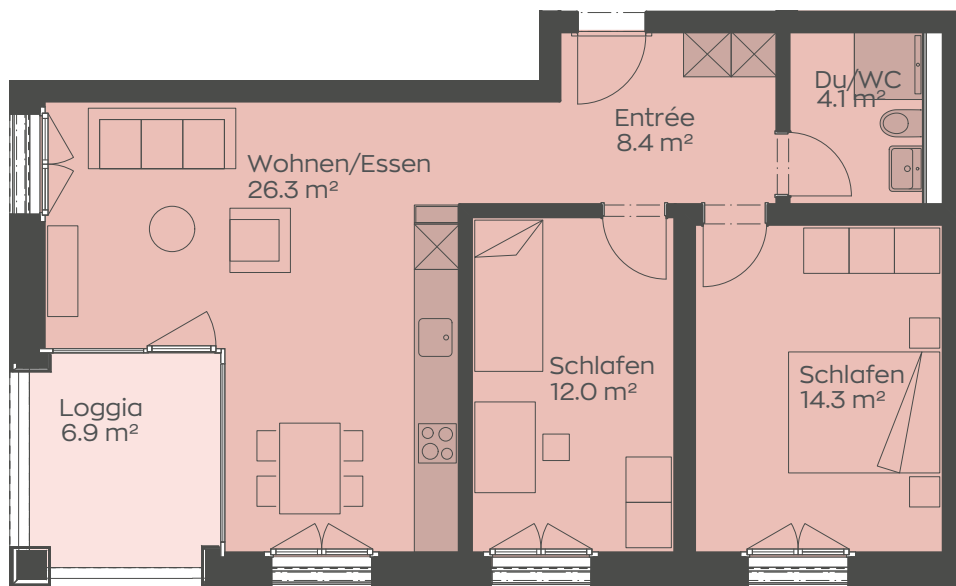
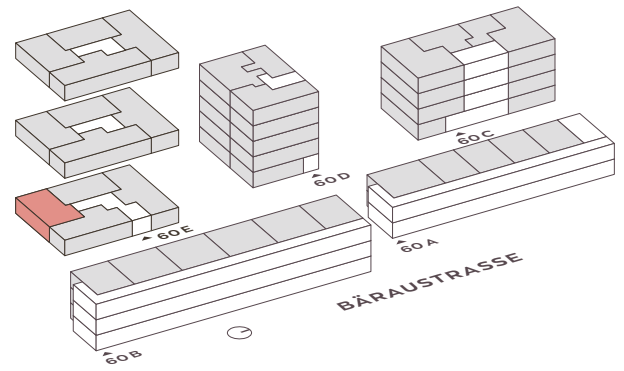

0 1 2 5m

MST. 1:100