

2½-zimmer-wohnungen

HAUS 2b	2b-106	1. Obergeschoss
	2b-206	2. Obergeschoss
HAUS 2c	2c-106	1. Obergeschoss
	2c-206	2. Obergeschoss

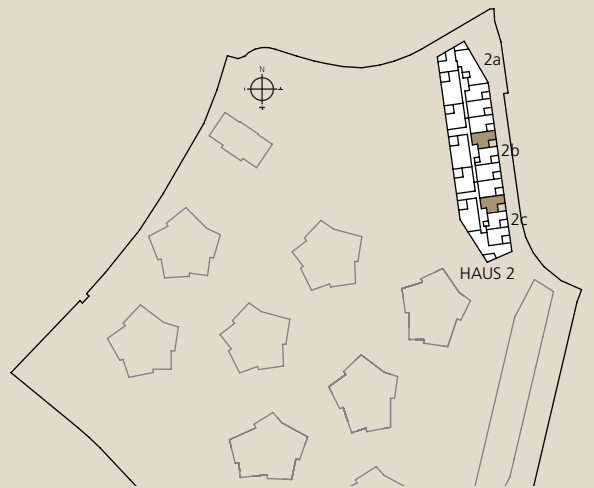

Wohnfläche **54.0 m²**
Loggia 1. + 2.OG **9.5 m²**

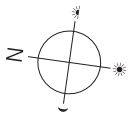

Masstab 1:100 (1cm = 1m)