

PROPRIETE DE FIDFUND MANAGEMENT S.A.

ETAT EXISTANT

Rue de Genève 88-88bis - 1004 Lausanne

ECH.: 1/200

DATE: 18.02.2020

DESS.: P.G.

**PLAN DU NIVEAU 6**

PROCIMMO SA  
CH.DE BUDRON H11- CP 413 - 1052 LE MONT-SUR-LAUSANNE  
T: 021/651.64.30 F: 021.651.64.41

FORMAT: 42 / 29.7

NUMERO:  
**118/007**

EXISTANT

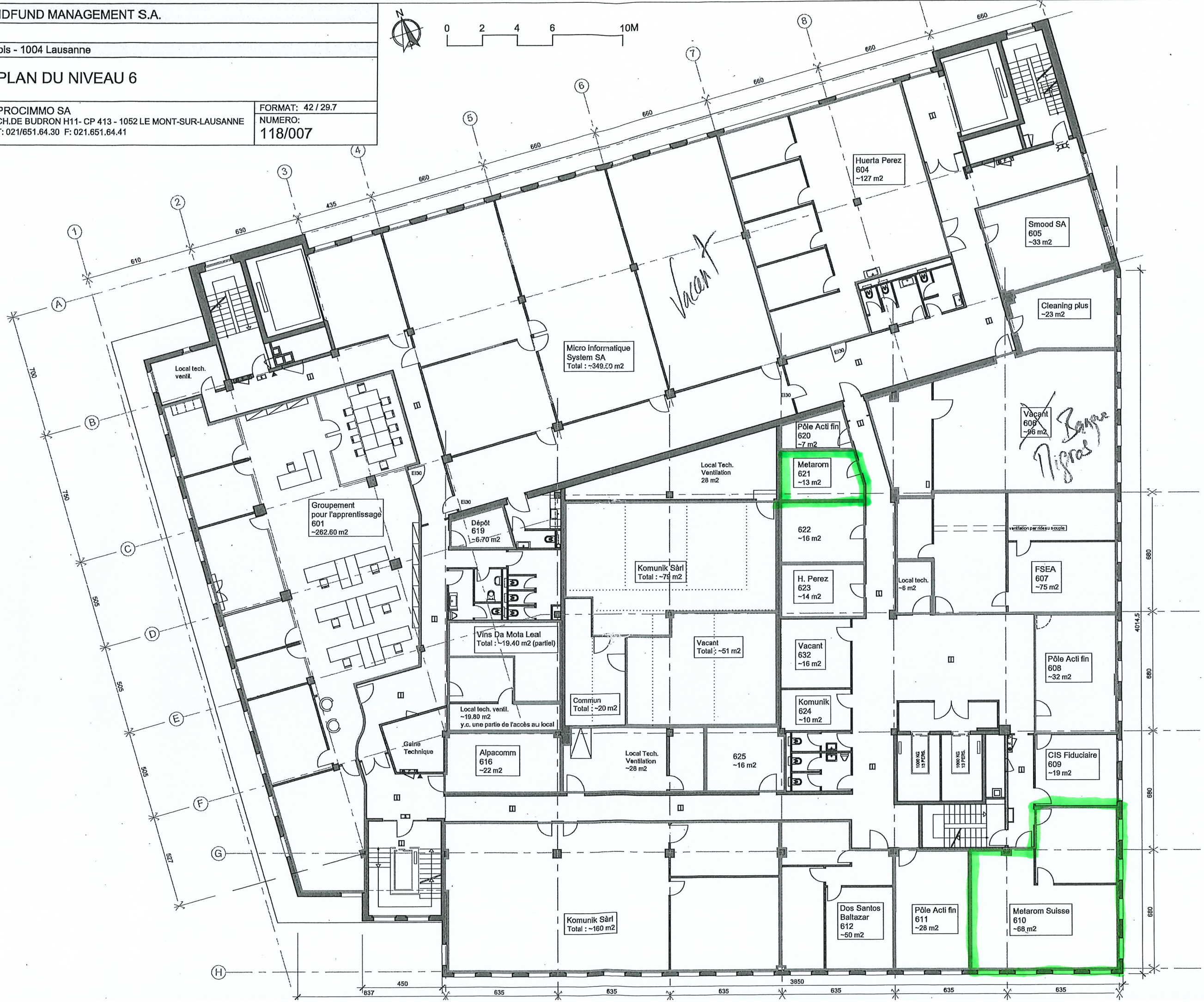
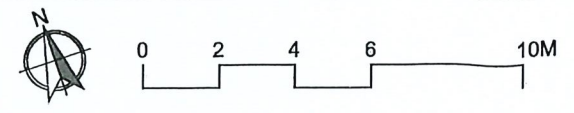

*Sanne  
Nigral*