

Internal Area	57,59 m <sup>2</sup>
Terrace	12,84 m <sup>2</sup>
<b>Total</b>	<b>70,43 m<sup>2</sup></b>
Yard	21,42 m <sup>2</sup>

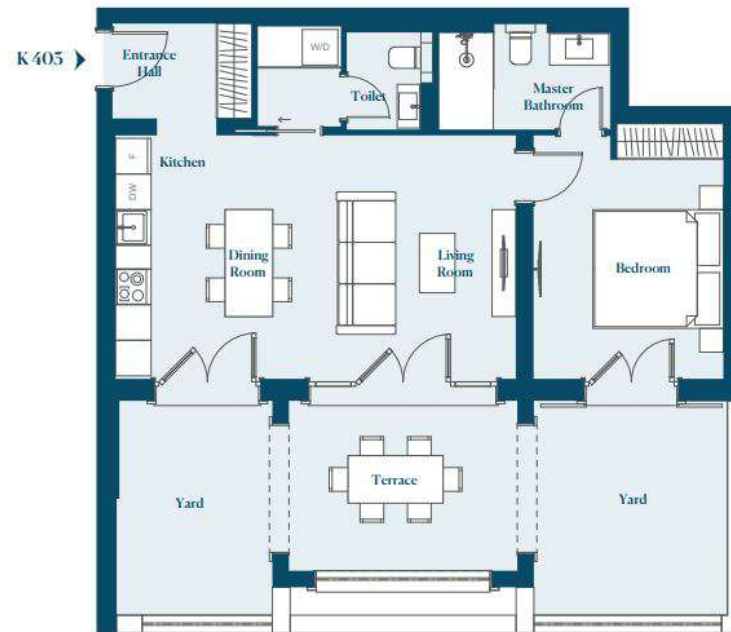

## Property Features

- Open plan living and dining areas
- Spacious balconies and terraces boasting gorgeous Adriatic Sea views
- Contemporary fixtures and spacious layouts
- Internal storage spaces
- Ducted air conditioning
- Audio intercom security access
- Access to a communal swimming pool
- Garage or a dedicated parking space lease
- Beach access

